

GC Fuji I



# GC Fuji I CAPSULE

GLASS IONOMER LUTING CEMENT

**Longer working time, yet shorter  
setting time means reduced  
chairside time!**

**Available in both  
Powder / Liquid and  
Capsules.**



# New Fuji I - GC take another step forward and set a new standard for glass ionomer luting cements.

Now Fuji I has been further improved by sophisticated state-of-the-art research techniques to provide an exceptional new material that will become the No.1 choice for dentists around the world.

Already Fuji I and Fuji I CAPSULE are internationally accepted thanks to the easy handling characteristics, excellent biocompatibility and physical properties.

Now with noticeable additional improvements in Fuji I, we believe you will find that GC will take the lead once again, this time in glass ionomer luting cements.

## Sharp Setting and Excellent Strength

The setting time of dental cements is one of the major factors affecting the placement technique and reliability in post operative prognosis. New Fuji I has a much faster setting time, providing rapid stabilization of the material and strong firm cementation. Cementation can now be completed much faster, meaning less chairside stress for both patient and dentist.

■ Comparison of Setting Property using a rheometer (room temperature : 23°C)

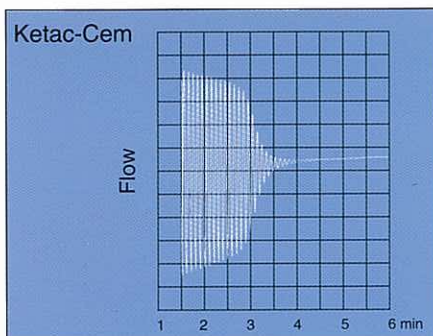
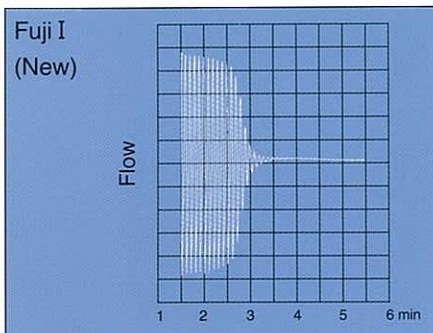

**One-push-opening method for powder bottle!**  
The bottle can be opened and closed with one hand.

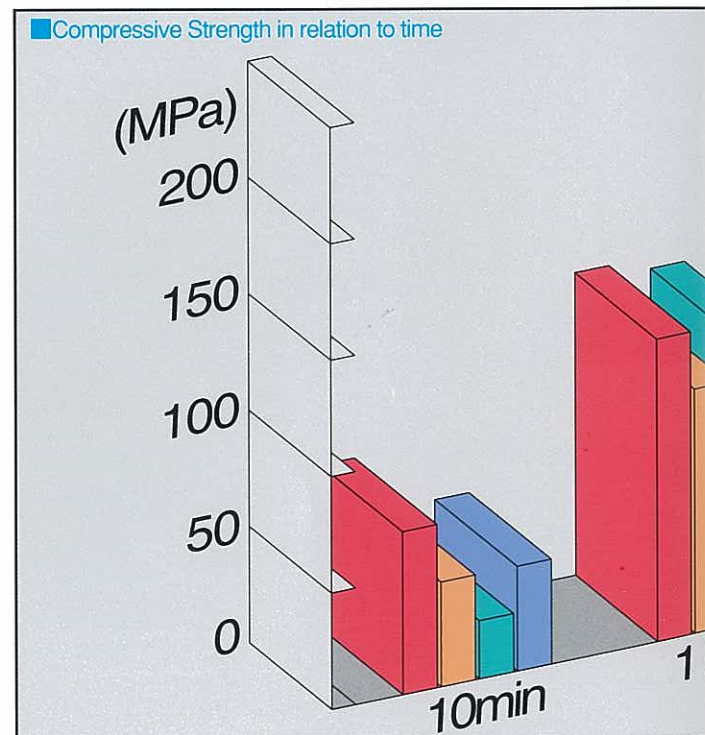

## Features

- |                   |   |
|-------------------|---|
| Biocompatibility  | Exhibits the excellent biocompatibility of a true glass ionomer which is kind to the pulp and gingival tissues.                                     |
| Adhesive strength | Offers strong chemical bonding to both enamel and dentin.   |
| Film thickness    | The mixed material has a film thickness of just 15 microns, providing excellent flow and complete sealing of the crown, bridge or orthodontic band. |

Fuji I CAPSULE is available  
in a neat foil.



### Easy Mixing, No Waiting, No Fuss

New Fuji I powder has excellent wetting properties, which means no need to divide powder into two halves. Simply take total quantity of powder required for cementation and mix with liquid in one time. No waiting, a smooth ultra creamy mix is obtained without effort in just 20 seconds. There is then a full 2 minutes working time, and snap set in the mouth.

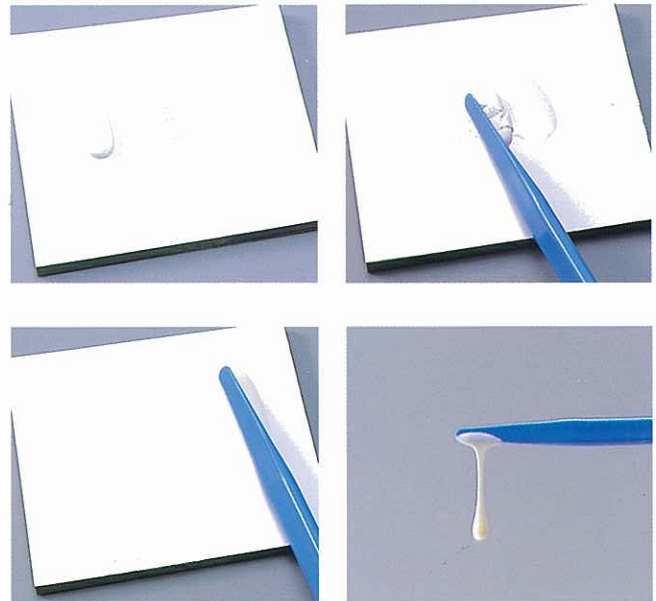

Fuji I CAPSULE with the new, metal GC Capsule Applier II.

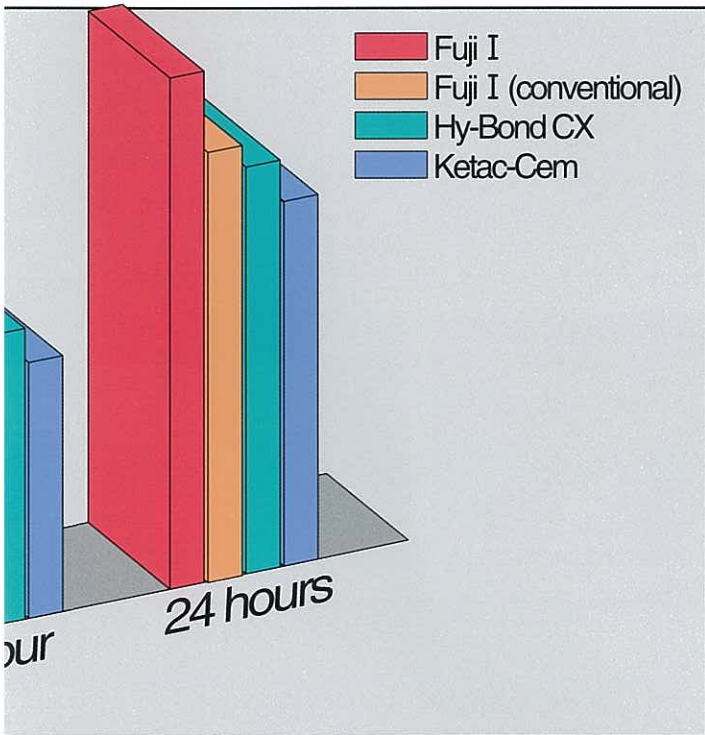

Solubility	The lowest solubility of any glass ionomer, providing long-term marginal seal.
Radiopacity	Excellent radiopacity enabling easy identification in post operative radiographs.
Fluoride release	Long-term continued fluoride release.

### Physical Properties

	Fuji I	Fuji I (CONVENTIONAL)	Hy-Bond CX	Ketac-Cem	
Powder / Liquid ratio (g/g)	1.8/1.0	1.8/1.0	2.0/1.0	3.8/1.0	
Working time (min., sec.)	2' 00"	1' 45"	1' 00"	2' 30"	
Net setting time(min., sec.)	※ 2' 30"	3' 00"	4' 50"	3' 00"	
Film thickness(μm)	※ 15	18	18	17	
Consistency(mm)	34	31	26	33	
Compressive strength(MPa)	After 10min.	73	48	29	48
	After 1 hour	137	102	126	104
	After 24 hours※	225	201	191	147
Adhesive strength(MPa)	Bovine enamel	5.1	5.0	4.2	3.8
	Bovine dentin	4.6	3.6	2.9	3.7
Solubility(%)	Distilled water	0.06	0.08	0.19	0.07
Surface hardness (Hv)	After 10 min.	19	11	12	13
	After 1 hour	31	29	28	31
	After 24 hours	51	47	48	50

※ISO 9917 : 1991(E)

(Values measured by GC Lab.)



# FULL RANGE OF GC GLASS IONOMER CEMENTS

## [For Cementing]



GC Fuji I



GC Fuji I CAPSULE



GC Fuji PLUS



GC Fuji PLUS CAPSULE

## [For Restorative Filling]



GC Fuji II LC Improved(light-cured)



GC Fuji II LC CAPSULE(light-cured)



GC Fuji II



GC Fuji II CAPSULE



GC Fuji IX



GC Fuji IX GP



GC Fuji IX GP CAPSULE

## [For Lining and Base]



GC Fuji LINING LC(light-cured)



LINING CEMENT

## [For Core build-up]



Miracle Mix



Miracle Mix CAPSULE

## [For Bonding]



GC Fuji BOND LC(light-cured)



GC Fuji ORTHO LC(light-cured)



GC Fuji ORTHO LC CAPSULE  
(light-cured)



GC Fuji ORTHO

## [For Pit and Fissure Sealing]



GC Fuji III

## (GC Fuji I)

- Shade : Light yellow

- Packages :

### I. Powder / Liquid

1. 1-1 package : 35g powder, 25g (20ml) liquid, powder scoop, mixing pads (No.20).
2. Bottle of 35g powder with scoop.
3. Bottle of 25g (20ml) liquid.

### II. Capsules (New design)

- Package : 50 capsules.  
(Average contents per capsule : 0.33g powder and 0.18g or 0.14ml liquid)

## GC CORPORATION

76-1 Hasunuma-cho, Itabashi-ku, Tokyo 174-8585, Japan Phone: 03-3558-5181 Fax: 03-3966-1470  
<http://www.gcdental.co.jp/>

For further information, please contact

GC EUROPE N.V. Research-Park, 13 Interleuvenlaan, B-3001 Leuven, Belgium Phone: 016-402700 Fax: 016-400214

GC GERMANY GmbH Paul-Gerhardt-Allee 50 D-81245 M - NCHEN, Germany Phone: 08989-66740 Fax: 08989-667429

GC FRANCE 8, Avenue du Bouton d'Or, F-94380 Bonneuil S/Marne, France Phone: 01-4980-3791 Fax: 01-4980-3790

GC ITALY S.r.l. Via Calabria,1(Sesto Ulteriano) I-20098 S. Giuliano Milanese (MI), Italy Phone: 02-98282068 Fax: 02-98282100

GC AMERICA INC. 3737 West 127th Street, Alsip, IL 60803 U.S.A. Phone: 708-597-0900 Fax: 708-371-5103

GC KOREA CO., LTD. Peeres Bldg. 5F, #222, Chungjeongno 3-Ga, Seodaemun-Gu, Seoul, 120-708 Korea Phone: 02-313-2272 Fax: 02-313-2275

GC TAIWAN CORP. 17 Lane 327, Chung-Shan RD, Ser 2, Chung-Ho City, Taipei Hsien, Taiwan Phone: 2-2246-3315 Fax: 2-2245-5072

GC ASIA DENTAL PTE. LTD. 19 Loyang Way, #06-27 Singapore 508724 Phone: 65-5467588 Fax: 65-5467577

Prior to use, carefully read the instructions for use included in the package.